

JIB ARM

JB-30

Operation Manual

WARNING

Before operating this equipment, please read this manual carefully and retain this for future reference. This equipment may cause harm, if not installed and used in accordance with this manual.

Contents

Main Features 2

Attention to users 3

Description of parts 4

Setting up the JIB ARM 5 • 6 • 7

Adjusting the friction 8

Positioning the main arm 8

Disassemble the JIB ARM 9

Caution for users 9

General specification 10

Main Features

- Easily mounted on 100mm bowl tripods or Pedestals.
- Either 75mm bowl or 100mm bowl heads can be installed.
- Maximum load capacity is up to 20kg. (includes head)
- Easy balancing by adjusting weights and counter arm length.
- Smooth operation without extra force.
- JB-30 can create unique image by adjusting length of main arm in anywhere which is impossible by tripods shooting.
- Easy disassembling for transportation with softcase.

CAUTION

This equipment may cause harm, if not installed and used in accordance with following instructions.

When setting up or disassembling this equipment, more than 2 person are required.

Fewer people may cause a dangerous situation such as collapse of the jib arm.

Make sure that tripod has ample capacity to cope with the weight of the jib arm.

Lower capacity tripod may cause camera damage or harm to users if it collapses.

Firmly tighten the lock lever and screw.

Without tightening lock and screw may cause damage to the camera or harmful to users.

Keep to the maximum load capacity.

Excess load capacity may cause damage to equipments and unexpected incident.

Careful operation with hand position.

Wrong position may cause pinch of fingers.

Careful attention is required when set up or disassemble this equipment.

Without attention may cause unexpected incident.

Do not dismantle or remold which cause breakdown of this equipment or harmful to users.

Description of parts

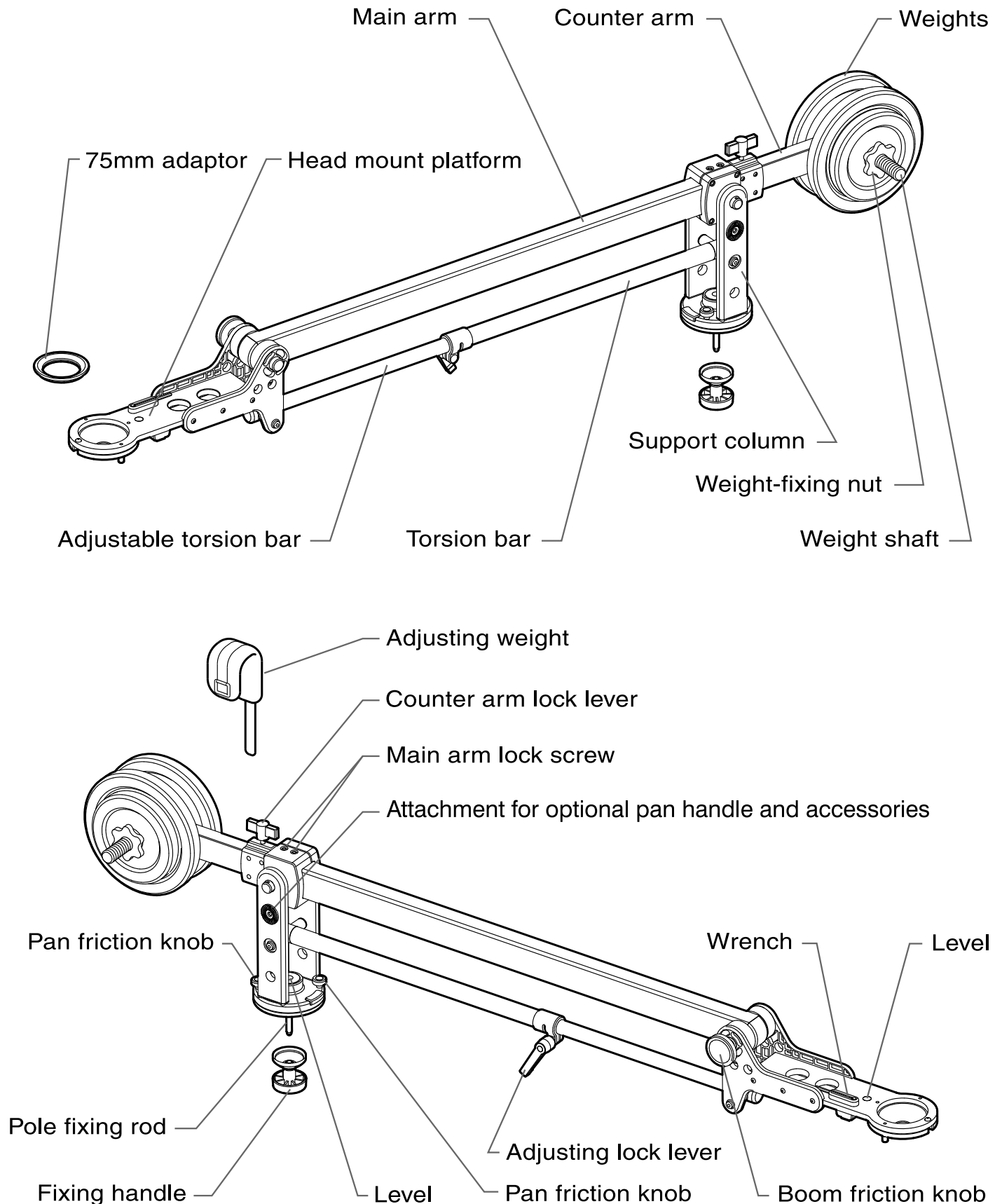

1 Remove all equipments

The jib arm, weight shaft lock and weight fixing nut are stored inside of softcase. Remove all equipments from inside.

2 Set up the jib arm

Move the folded head mount platform and support column as to shown on the diagram in order to connect the adjustable torsion bar to torsion bar. (Adjusting lock lever should be free during this operation.)

Attach the adjustable torsion bar to torsion bar to the indicated line and tighten firmly adjusting lock lever.

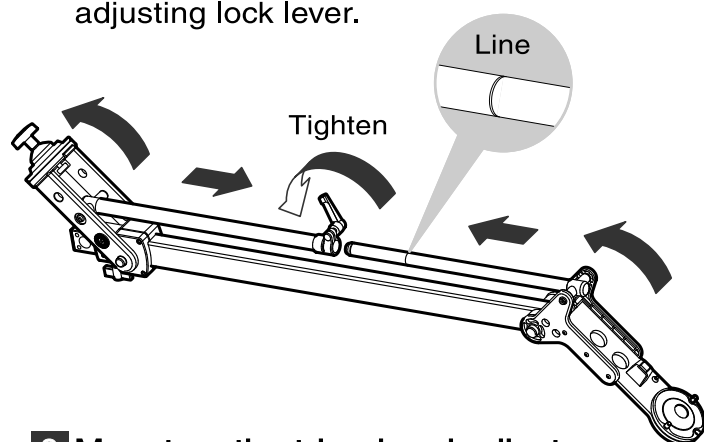

3 Mount on the tripod and adjust the leveling

- ① Position the jib arm onto 100 mm bowl tripod. From below the 100mm bowl, connect the jib arm to the tripod with the fixing handle knob.
- ② Lift up main jib arm and gently adjust the tripod height for leveling.

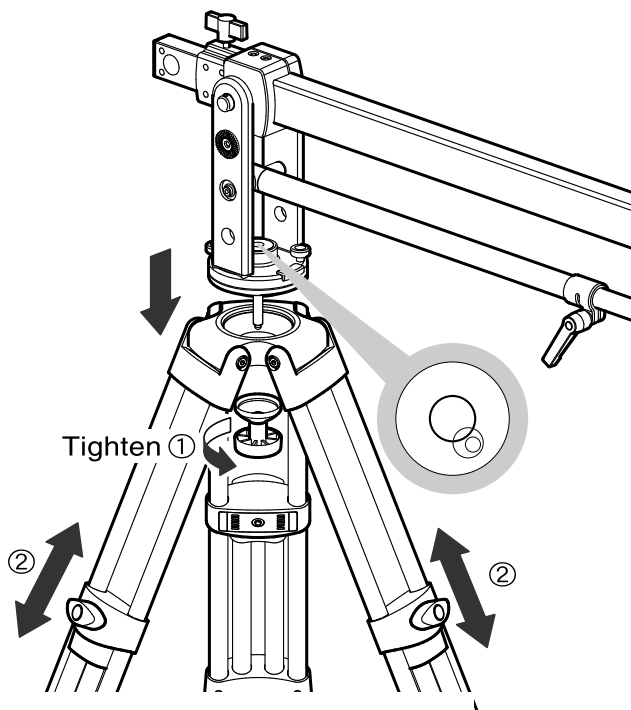

4 Head attachment

Lower the jib arm to the lowest position and fix the head on the bowl in the same way as when the head is usually mounted on tripod. (adapter for 75mm bowl head as same way)

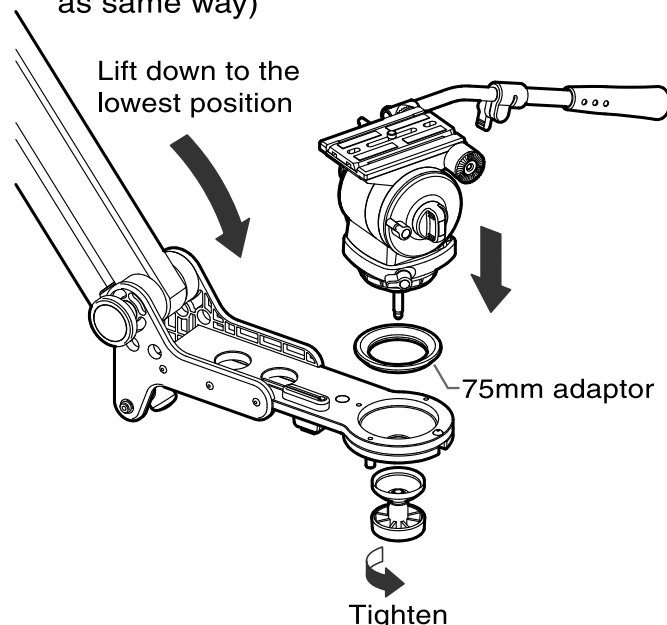

5 Weights attachment

⚠ CAUTION Please be carefully operate when attach the weights. Main arm will lift up.

- ① Unlock the counter arm lock lever and telescope out the counter arm slightly.
- ② Lock the counter arm lock lever firmly for positioning.
- ③ Mount the longer weight shaft bar by threading the hole.
- ④ Attach the weights, 5kg first and 2.5kg second to either side and fix them into place.

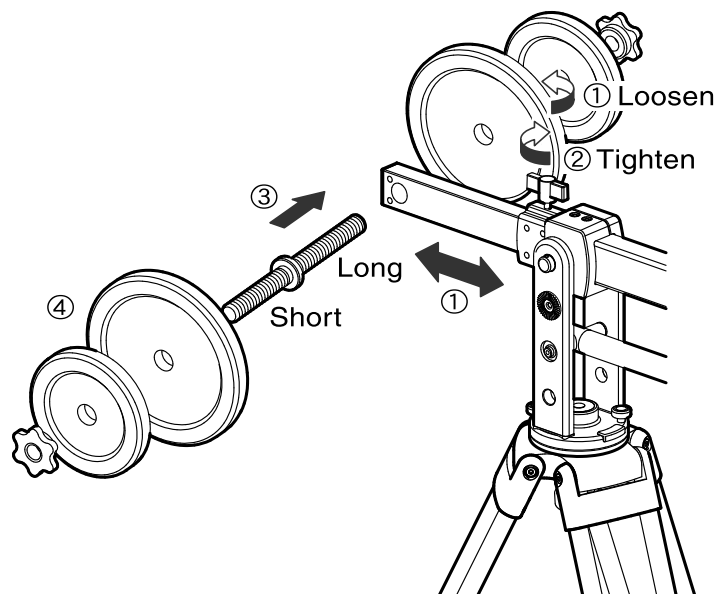

6 Adjust the jib arm leveling

- ① Unlock the counter arm lock lever and telescope out the counter arm for adjusting the balance. Then, adjust the lock lever for adjustable torsion bar in order to level the head mount platform.
- ② Once the level is achieved, lock the adjusting lock lever firmly.

- ③ Unlock the adjusting lock lever for inner support arm in and out in order to level the head mount platform.
- ④ Once the level is achieved, lock the adjusting lock lever firmly.

⚠ CAUTION

During this operation, the label indicated position is harmful for pinching fingers.

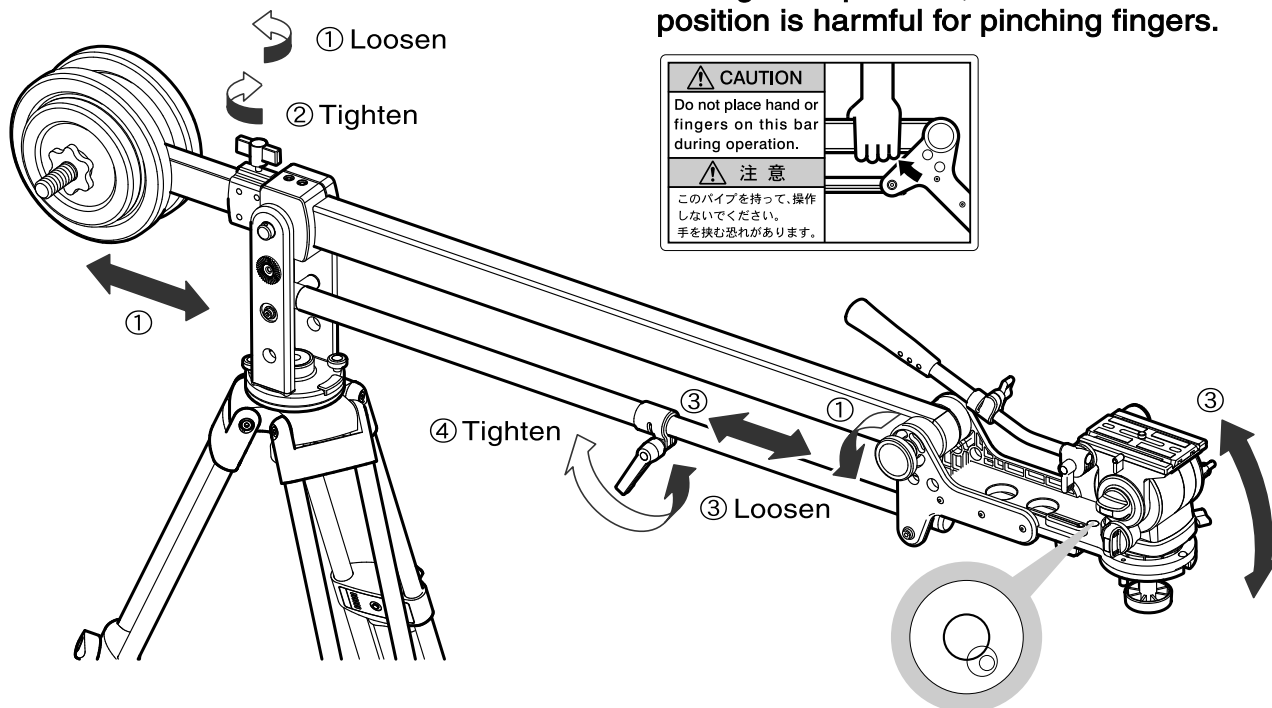
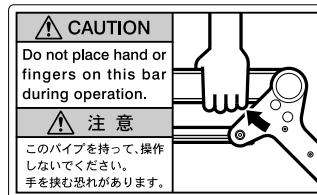

7 Mount the head

Put the head on the bowl adaptor and fix it by clamping the handle in the same way as when the head is usually mounted on a tripod.

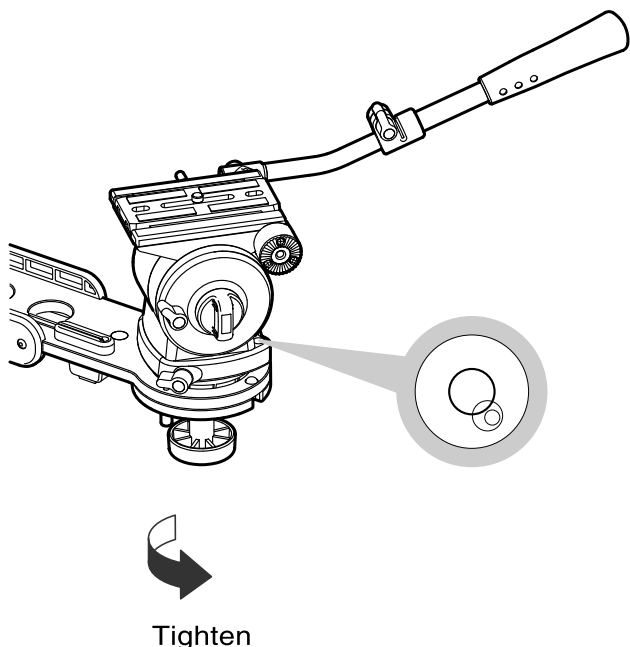

8 Mount the camera

The maximum load capacity includes head is 20kg.

Do not excess load capacity.

Lower the jib arm to its lowest position and support the tripod not allowing it to tip down.

Mount the camera onto the head.

⚠ CAUTION Please be careful when camera mounted. The head position will be heavier.

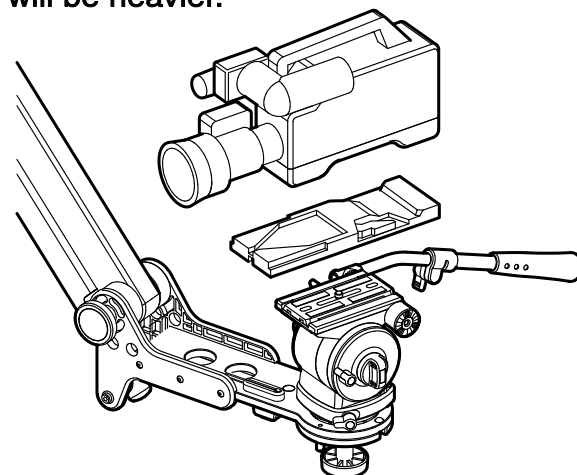

9 Adjusting the counter balance weights

⚠ CAUTION Please carefully operate, additional gravity is occurred.

① Loosen the counter arm lock lever.

② Telescoping the counter arm in and out for fine-tuning. Attached small adjusting weight can be used for last counter balance achievement.

③ Once counter balance is achieved, lock the counter arm lock lever firmly.

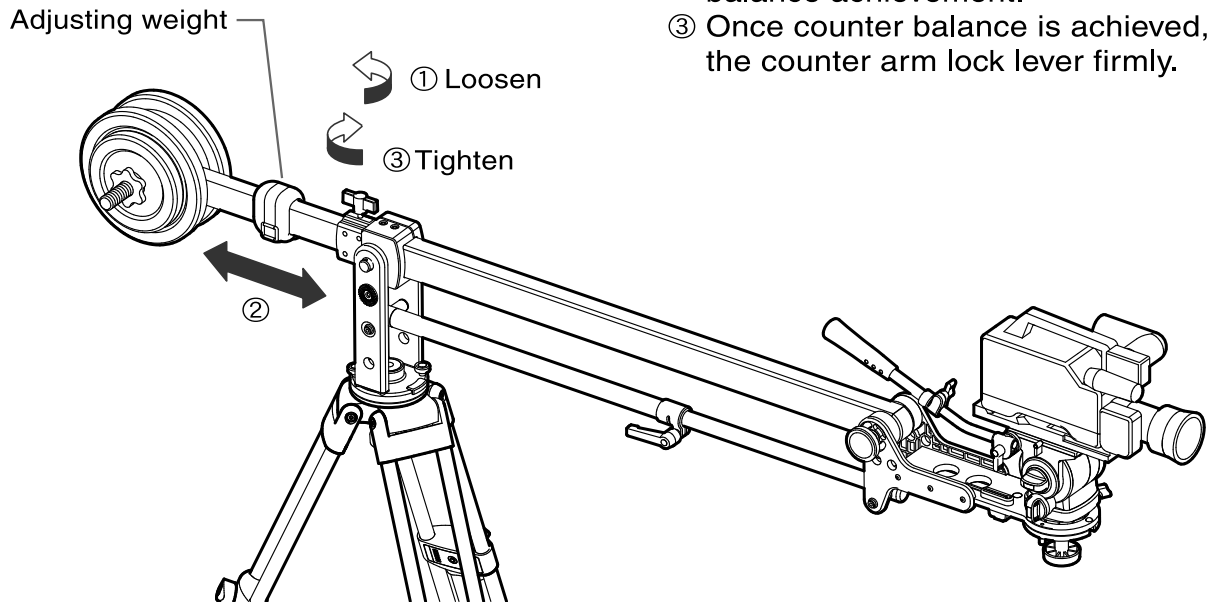

10 Operate the jib arm

You may hold the weight shaft during the operation.

⚠ CAUTION

During this operation, the label indicated position is harmful for pinching fingers.

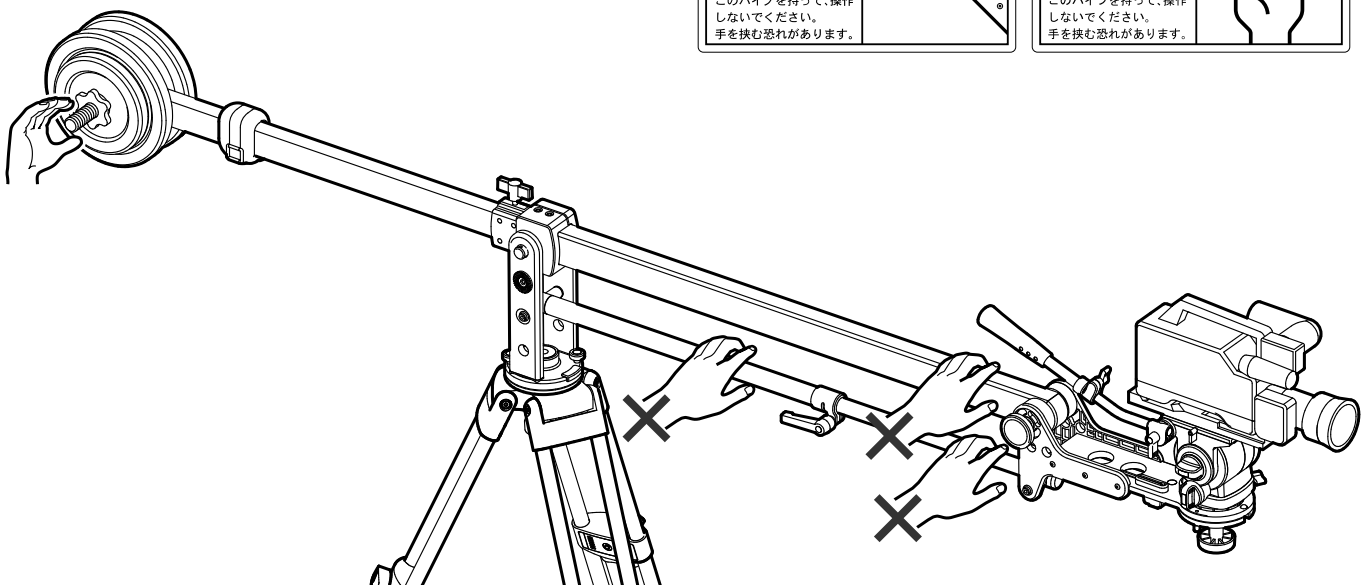
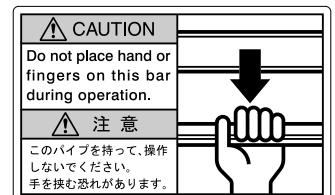

Adjusting the friction

Pan friction

When stronger friction is required, turn the friction knob clockwise. For weaker friction turn the knob counter-clockwise. **There are 2 knobs which can be adjustable.**

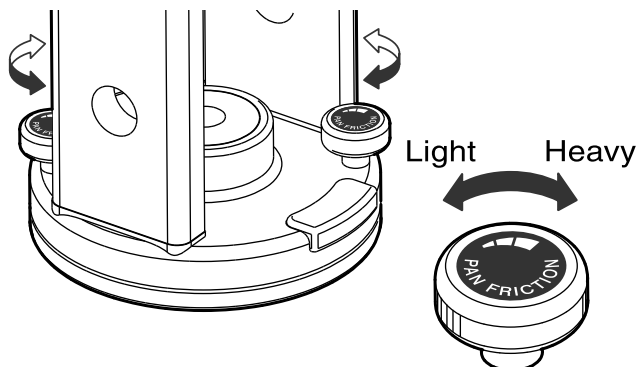

Boom friction

When stronger friction is required, turn the friction knob clockwise. For weaker friction turn the knob counter-clockwise. **Weak friction point is limited, do not overturn the knob.**

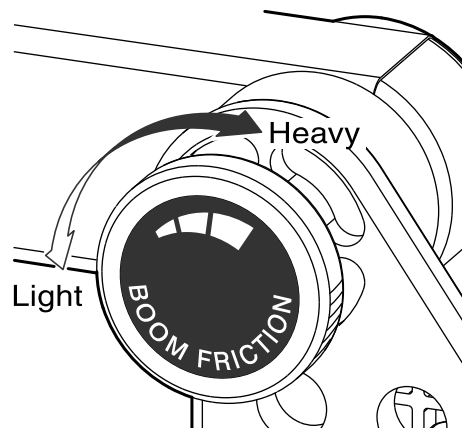

Positioning the main arm

JB-30' main arm is available to be shorter 40cm depending on the circumstances.

⚠ CAUTION When it is required, remove the camera, head and weights.

- ① Unlock the adjusting lock lever and loosen the main jib arm lock screw by turning the screw counter clockwise using attached wrench.
- ② Tune the appropriate position for both main jib arm and the adjustable torsion bar.
- ③ Once achieved the positioning, tighten the main arm lock screw clockwise by using attached wrench.
- ④ Then, adjust the leveling using the bubble level.
- ⑤ Tighten the adjusting lock lever firmly for operation.

⚠ CAUTION

During this operation, the label indicated position is harmful for pinching fingers.

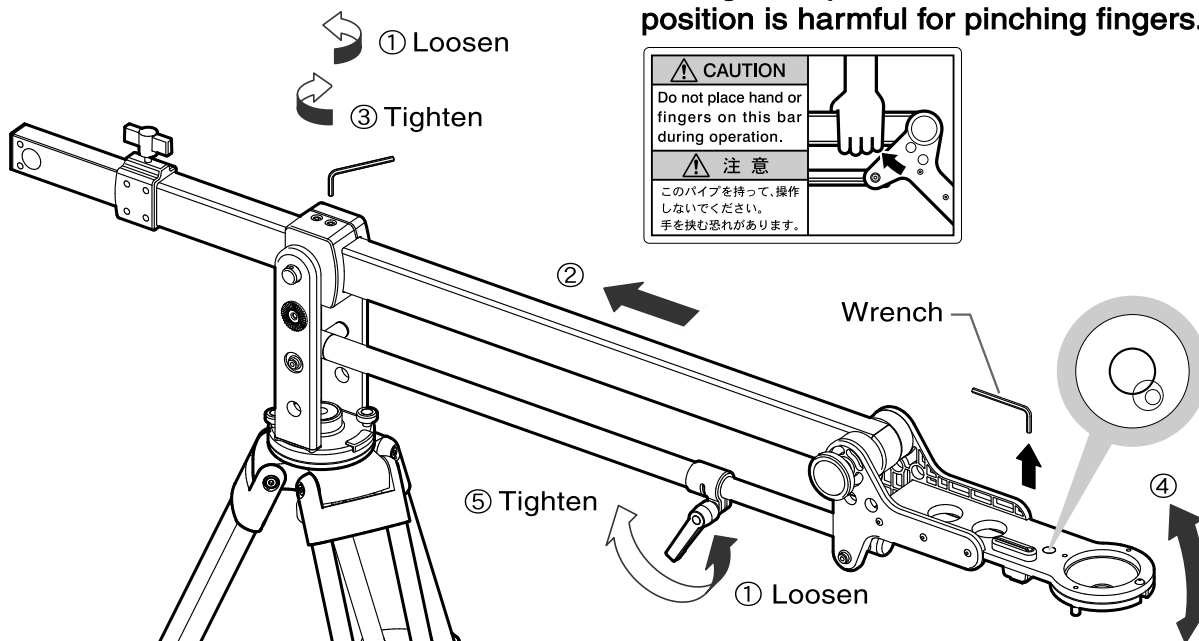

Disassemble the JIB ARM

Please handle jib arm carefully.

1 Remove the camera and head

CAUTION Telescope the counter arm in at minimum length and remove the camera and head.

2 Remove the weights and weight shaft screw

CAUTION Be sure that once weights are removed, gravity would be applied to the head.

3 Shorten the counter arm

Loosen the counter arm lock and telescope the counter arm in at minimum position. Then, lock firmly the counter arm lock lever.

4 Remove the jib from tripod

Remove the attached fixing handle and put it to rod.

5 Fold the jib arm

Loosen the adjusting lock lever and pull out the adjustable torsion bar.

6 Stow in softcase

Fix the torsion bar and the adjustable torsion bar using the band. Install the weight shaft screw and weight-fixing nut inside of the pocket shown in diagram.

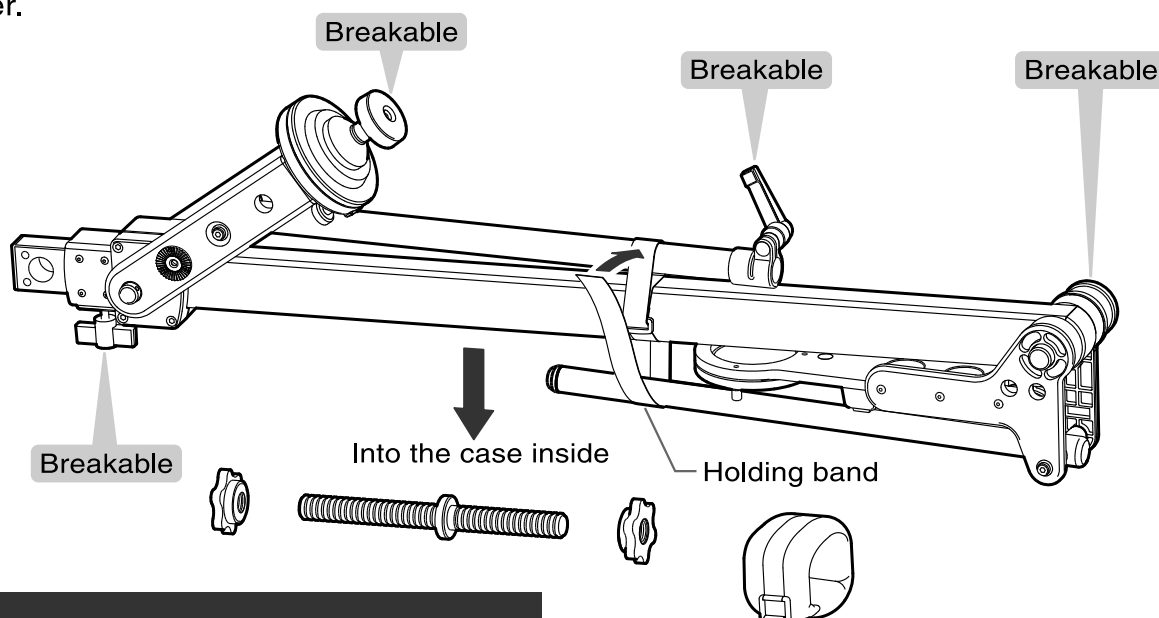

Caution for users

Pan and boom friction

Unnecessary boom friction will cause jib arm fall down.

After operation

Detach camera, weights and telescope the counter arm at the minimum position. Stay the head at the lowest position.

When transportation

Please stow in the case

Operation for adjusting lock lever

The position of lock lever can be adjustable in order not to hit to the tripod during the operation.

Once lock the arm clockwise, pull up the lever and adjust the position as parallel to torsion bar.

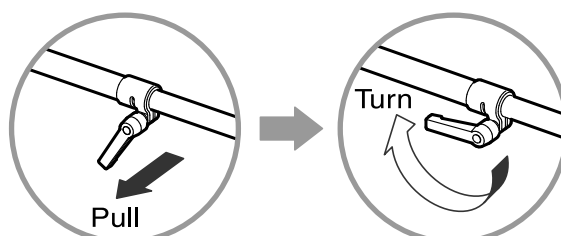

General specification

Maximum load capacity : 20kg(includes head)

Pan radius :
at its minimum length 1010mm
at its maximum length 1415mm

Boom dimension : 1030mm ~ 1725mm

Weight ratio : 1:1

Weight : 10kg

Bowl level diameter : $\phi 100\text{mm}$ / $\phi 75\text{mm}$ (adaptor attached)

Applicable tripod : $\phi 100\text{mm}$ bowl tripod

Accessories : Weight shaft $\times 1$, Weight-fixing nut $\times 2$, $\phi 75\text{mm}$ adaptor $\times 1$
Carrying case $\times 1$, Wrench $\times 1$, Adjusting weight(1kg) $\times 1$

■ Main arm maximum height

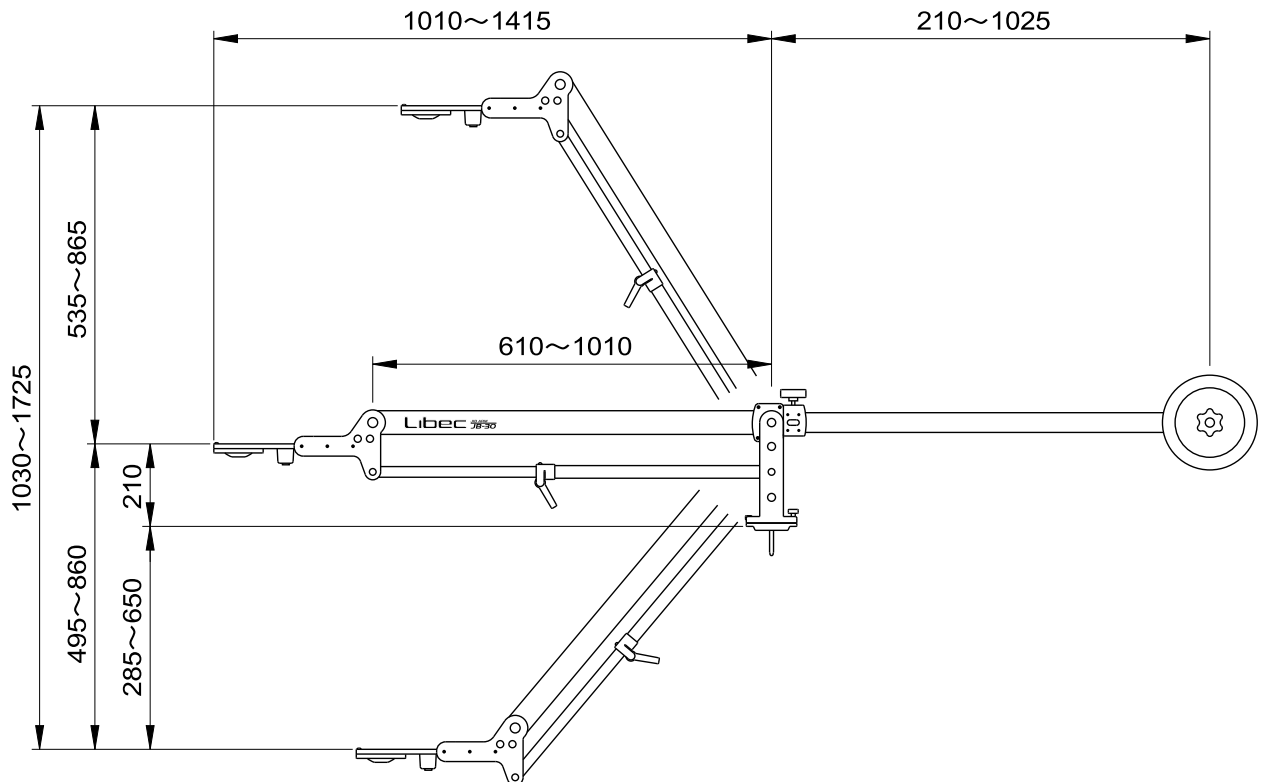

■ Main arm minimum height

Load capacity 30kg is applicable at the main arm minimum extension 610mm.

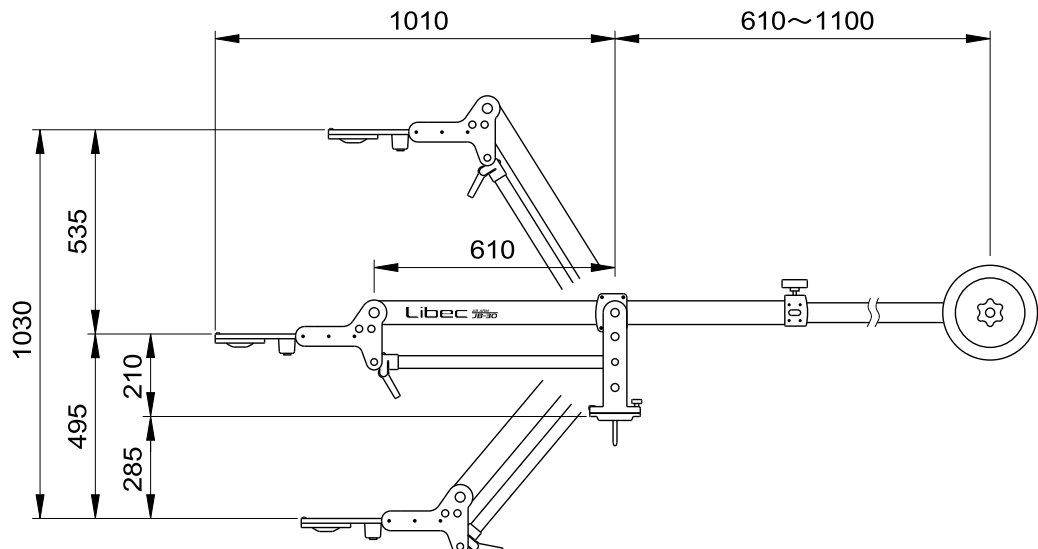

Manufacturer :
HEIWA SEIKI KOGYO CO.,LTD.
978-1,Nishibukuro,Yashio-City,Saitama,340Japan
TEL : 048-995-1301
FAX : 048-997-0804
<http://www.libec.co.jp>

JB-30 Additional safety lock

Additional safety lock has been included for better securing the adjustable torsion bar. Use this safety lock when you set up or adjust the equipment.

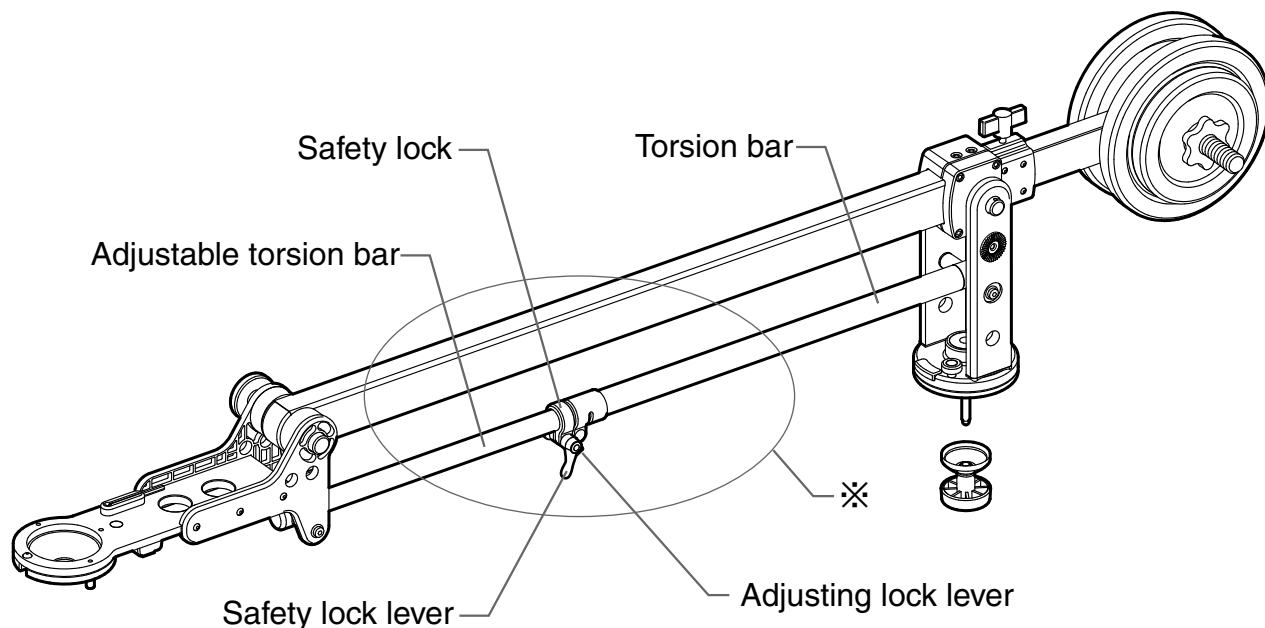

■ Loosen the torsion bar

- ① Loosen the safety lock lever
- ② Loosen the adjustable torsion bar

■ Tighten the torsion bar

- ③ Tighten the adjustable torsion bar
- ④ Safety lock should be located toward the torsion bar
- ⑤ Tighten the safety lock lever

※ Safety lock lever - Enlargement

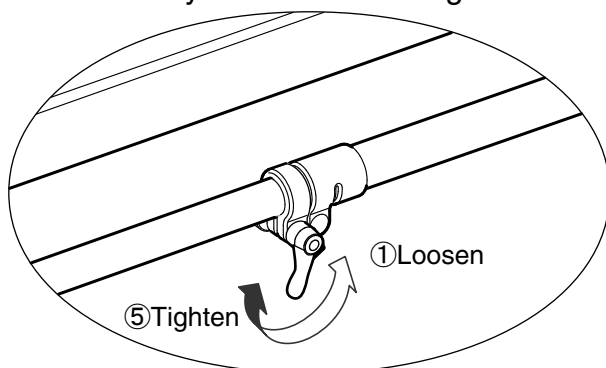

※ Adjusting lock lever - Enlargement

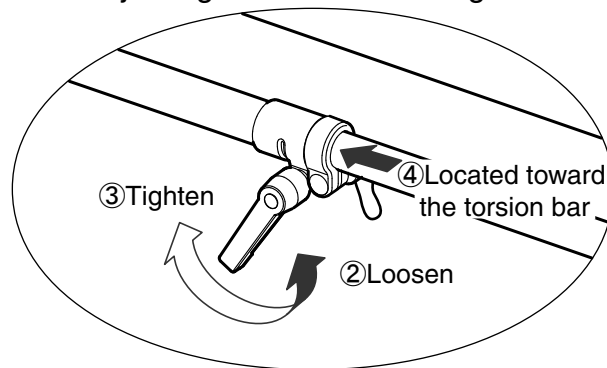

Ensure that the safety lock lever is installed at the opposite side of the adjusting lock lever as shown in the figure above. Setting up both at the same direction may cause malfunction to locking system.

⚠ CAUTION

Loosen the safety lock lever when setting up the equipment. It may cause pinching fingers when the safety lock is tightened.

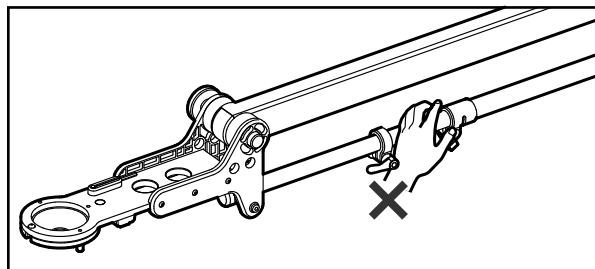

HEIWA SEIKI KOGYO CO., LTD. JAPAN
978-1 NISHIBUKURO, YASHIO, SAITAMA, 340-0833 JAPAN
Phone: 048-995-1301 FAX: 048-997-0804
<http://www.libec.co.jp>